



PASADORES

DIN 6325. DIN 7979/D. DIN 7. DIN 1B. Pasadores estriados. Remaches estriados.

DIN 6325

d	1	1,5	2	2,5	3	4	5	6	8	10	12	14	16	20
l_2	0,4	0,5	0,6	0,7	0,8	1	1,2	1,5	1,8	2	2,5	2,5	3	4
r	1	1,6	2	2,5	3	4	5	6	8	10	12	16	16	20
z_1	0,15	0,23	0,3	0,4	0,45	0,6	0,75	0,9	1,2	1,5	1,8	2	2,5	3
z_2	0,08	0,12	0,18	0,25	0,3	0,4	0,5	0,6	0,8	1	1,3	1,3	1,7	2

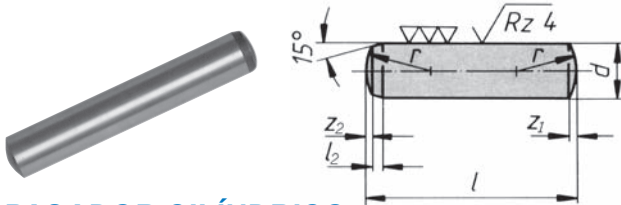

PASADOR CILÍNDRICO

Material 100 Cr6 garantizado. Tolerancia m6.

Templado 60 ±2 HRC y rectificado.

Referencia	d x l
D250-1-4	1x04
D250-1-5	1x05
D250-1-6	1x06
D250-1-8	1x08
D250-1-10	1x10
D250-1-12	1x12
D250-1-14	1x14
D250-1-16	1x16
<hr/>	
D250-1,5-5	1,5x05
D250-1,5-6	1,5x06
D250-1,5-8	1,5x08
D250-1,5-10	1,5x10
D250-1,5-12	1,5x12
D250-1,5-14	1,5x14
D250-1,5-16	1,5x16
D250-1,5-18	1,5x18
D250-1,5-20	1,5x20
D250-1,5-22	1,5x22
D250-1,5-24	1,5x24
D250-1,5-26	1,5x26
D250-1,5-28	1,5x28
D250-1,5-30	1,5x30
<hr/>	
D250-2-6	2x06
D250-2-8	2x08
D250-2-10	2x10
D250-2-12	2x12
D250-2-14	2x14
D250-2-16	2x16
D250-2-18	2x18
D250-2-20	2x20
D250-2-22	2x22
D250-2-24	2x24
D250-2-26	2x26
D250-2-28	2x28
D250-2-30	2x30
D250-2-32	2x32
D250-2-36	2x36
D250-2-40	2x40
<hr/>	
D250-2,5-6	2,5x06
D250-2,5-8	2,5x08
D250-2,5-10	2,5x10
D250-2,5-12	2,5x12
D250-2,5-14	2,5x14
D250-2,5-16	2,5x16

continuación ▼

Referencia	d x l
D250-2,5-18	2,5x18
D250-2,5-20	2,5x20
D250-2,5-22	2,5x22
D250-2,5-24	2,5x24
D250-2,5-26	2,5x26
D250-2,5-28	2,5x28
D250-2,5-30	2,5x30
D250-2,5-32	2,5x32
D250-2,5-36	2,5x36
D250-2,5-40	2,5x40
D250-2,5-45	2,5x45
D250-2,5-50	2,5x50
<hr/>	
D250-3-6	3x06
D250-3-8	3x08
D250-3-10	3x10
D250-3-12	3x12
D250-3-14	3x14
D250-3-16	3x16
D250-3-18	3x18
D250-3-20	3x20
D250-3-22	3x22
D250-3-24	3x24
D250-3-26	3x26
D250-3-28	3x28
D250-3-30	3x30
D250-3-32	3x32
D250-3-36	3x36
D250-3-40	3x40
D250-3-45	3x45
D250-3-50	3x50
D250-3-55	3x55
D250-3-60	3x60
<hr/>	
D250-4-6	4x06
D250-4-8	4x08
D250-4-10	4x10
D250-4-12	4x12
D250-4-14	4x14
D250-4-16	4x16
D250-4-18	4x18
D250-4-20	4x20
D250-4-22	4x22
D250-4-24	4x24
D250-4-26	4x26
D250-4-28	4x28
D250-4-30	4x30
D250-4-32	4x32
D250-4-36	4x36
D250-4-40	4x40
D250-4-45	4x45
D250-4-50	4x50
D250-4-55	4x55
D250-4-60	4x60
<hr/>	
D250-5-8	5x08
D250-5-10	5x10
D250-5-12	5x12



PASADORES

DIN 6325. DIN 7979/D. DIN 7. DIN 1B. Pasadores estriados. Remaches estriados.

continuación ▾

Referencia	d x l
D250-5-14	5x14
D250-5-16	5x16
D250-5-18	5x18
D250-5-20	5x20
D250-5-22	5x22
D250-5-24	5x24
D250-5-26	5x26
D250-5-28	5x28
D250-5-30	5x30
D250-5-32	5x32
D250-5-36	5x36
D250-5-40	5x40
D250-5-45	5x45
D250-5-50	5x50
D250-5-55	5x55
D250-5-60	5x60
<hr/>	
D250-6-10	6x10
D250-6-12	6x12
D250-6-14	6x14
D250-6-16	6x16
D250-6-18	6x18
D250-6-20	6x20
D250-6-22	6x22
D250-6-24	6x24
D250-6-26	6x26
D250-6-28	6x28
D250-6-30	6x30
D250-6-32	6x32
D250-6-36	6x36
D250-6-40	6x40
D250-6-45	6x45
D250-6-50	6x50
D250-6-55	6x55
D250-6-60	6x60
D250-6-70	6x70
D250-6-80	6x80
D250-6-90	6x90
D250-6-100	6x100
<hr/>	
D250-8-14	8x14
D250-8-16	8x16
D250-8-18	8x18
D250-8-20	8x20
D250-8-22	8x22
D250-8-24	8x24
D250-8-26	8x26
D250-8-28	8x28
D250-8-30	8x30
D250-8-32	8x32
D250-8-36	8x36
D250-8-40	8x40
D250-8-45	8x45
D250-8-50	8x50
D250-8-55	8x55
D250-8-60	8x60
D250-8-70	8x70
D250-8-80	8x80
D250-8-90	8x90
D250-8-100	8x100
D250-8-120	8x120
<hr/>	
D250-10-16	10x16
D250-10-18	10x18
D250-10-20	10x20
D250-10-22	10x22
D250-10-24	10x24
D250-10-26	10x26
D250-10-28	10x28
D250-10-30	10x30
D250-10-32	10x32

continuación ▾

Referencia	d x l
D250-10-36	10x36
D250-10-40	10x40
D250-10-45	10x45
D250-10-50	10x50
D250-10-55	10x55
D250-10-60	10x60
D250-10-70	10x70
D250-10-80	10x80
D250-10-90	10x90
D250-10-100	10x100
D250-10-120	10x120
<hr/>	
D250-12-20	12x20
D250-12-22	12x22
D250-12-24	12x24
D250-12-26	12x26
D250-12-28	12x28
D250-12-30	12x30
D250-12-32	12x32
D250-12-36	12x36
D250-12-40	12x40
D250-12-45	12x45
D250-12-50	12x50
D250-12-55	12x55
D250-12-60	12x60
D250-12-70	12x70
D250-12-80	12x80
D250-12-90	12x90
D250-12-100	12x100
D250-12-120	12x120
<hr/>	
D250-14-24	14x24
D250-14-26	14x26
D250-14-28	14x28
D250-14-30	14x30
D250-14-32	14x32
D250-14-36	14x36
D250-14-40	14x40
D250-14-45	14x45
D250-14-50	14x50
D250-14-55	14x55
D250-14-60	14x60
D250-14-70	14x70
D250-14-80	14x80
D250-14-90	14x90
D250-14-100	14x100
D250-14-120	14x120
<hr/>	
Referencia	d x l
D250-16-24	16x24
D250-16-26	16x26
D250-16-28	16x28
D250-16-30	16x30
D250-16-32	16x32
D250-16-36	16x36
D250-16-40	16x40
D250-16-45	16x45
D250-16-50	16x50
D250-16-55	16x55
D250-16-60	16x60
D250-16-70	16x70
D250-16-80	16x80
D250-16-90	16x90
D250-16-100	16x100
D250-16-120	16x120
<hr/>	
D250-20-40	20x40
D250-20-45	20x45
D250-20-50	20x50
D250-20-55	20x55

sigue :▶

sigue :▶



PASADORES

DIN 6325. DIN 7979/D. DIN 7. DIN 1B. Pasadores estriados. Remaches estriados.

continuación ▾

Referencia	d x l
D250-20-60	20x60
D250-20-70	20x70
D250-20-80	20x80

sigue ▶

Referencia	d x l
D250-20-90	20x90
D250-20-100	20x100
D250-20-120	20x120

DIN 7979/D

d	4	5	6	8	10	12	14	16	20
d ₁	M2,5-3	M3	M4	M5	M6	M6	M8	M8	M10
c ₁	0,4	0,5	0,6	0,8	1	1,2	1,4	1,6	2
c ₂	1,4	1,7	2,1	2,6	3	3,8	4	4,7	6
t ₁	4	5	6	8	10	10	12	12	16
t ₂	8	8	10	12	16	16	20	20	25

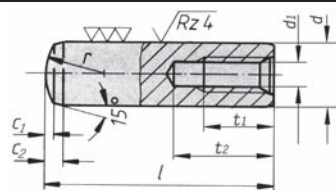
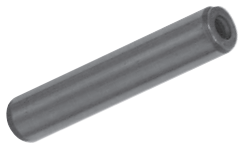

PASADOR CILÍNDRICO CON ROSCA INTERIOR

Material 100 Cr6 garantizado. Tolerancia m6.

Templado 60 ±2 HRC y rectificado.

Referencia	d x l
D790-4-10	4x10
D790-4-12	4x12
D790-4-14	4x14
D790-4-16	4x16
D790-4-18	4x18
D790-4-20	4x20
D790-4-24	4x24
D790-4-28	4x28
D790-4-30	4x30
D790-4-32	4x32
D790-4-36	4x36
D790-4-40	4x40
D790-4-45	4x45
D790-4-50	4x50
D790-5-10	5x10
D790-5-12	5x12
D790-5-14	5x14
D790-5-16	5x16
D790-5-18	5x18
D790-5-20	5x20
D790-5-24	5x24
D790-5-28	5x28
D790-5-30	5x30
D790-5-32	5x32
D790-5-36	5x36
D790-5-40	5x40
D790-5-45	5x45
D790-5-50	5x50
D790-6-12	6x12
D790-6-14	6x14
D790-6-16	6x16
D790-6-18	6x18
D790-6-20	6x20
D790-6-24	6x24
D790-6-28	6x28
D790-6-30	6x30

sigue ▶

continuación ▾

Referencia	d x l
D790-6-32	6x32
D790-6-36	6x36
D790-6-40	6x40
D790-6-45	6x45
D790-6-50	6x50
D790-6-55	6x55
D790-6-60	6x60
D790-8-16	8x16
D790-8-18	8x18
D790-8-20	8x20
D790-8-24	8x24
D790-8-28	8x28
D790-8-30	8x30
D790-8-32	8x32
D790-8-36	8x36
D790-8-40	8x40
D790-8-45	8x45
D790-8-50	8x50
D790-8-55	8x55
D790-8-60	8x60
D790-8-70	8x70
D790-8-80	8x80
D790-8-90	8x90
D790-8-100	8x100
D790-10-16	10x16
D790-10-20	10x20
D790-10-24	10x24
D790-10-28	10x28
D790-10-30	10x30
D790-10-32	10x32
D790-10-36	10x36
D790-10-40	10x40
D790-10-45	10x45
D790-10-50	10x50
D790-10-55	10x55
D790-10-60	10x60
D790-10-70	10x70
D790-10-80	10x80
D790-10-90	10x90
D790-10-100	10x100
D790-10-120	10x120
Referencia	d x l
D790-12-20	12x20
D790-12-24	12x24
D790-12-28	12x28
D790-12-30	12x30

sigue ▶



PASADORES

DIN 6325. DIN 7979/D. DIN 7. DIN 1B. Pasadores estriados. Remaches estriados.

continuación ▼

Referencia	d x l
D790-12-32	12x32
D790-12-36	12x36
D790-12-40	12x40
D790-12-45	12x45
D790-12-50	12x50
D790-12-55	12x55
D790-12-60	12x60
D790-12-70	12x70
D790-12-80	12x80
D790-12-90	12x90
D790-12-100	12x100
D790-12-120	12x120
<hr/>	
D790-14-32	14x32
D790-14-36	14x36
D790-14-40	14x40
D790-14-45	14x45
D790-14-50	14x50
D790-14-55	14x55
D790-14-60	14x60
D790-14-70	14x70
D790-14-80	14x80
D790-14-90	14x90
D790-14-100	14x100
D790-14-120	14x120

sigue

Referencia	d x l
D790-16-32	16x32
D790-16-36	16x36
D790-16-40	16x40
D790-16-45	16x45
D790-16-50	16x50
D790-16-55	16x55
D790-16-60	16x60
D790-16-70	16x70
D790-16-80	16x80
D790-16-90	16x90
D790-16-100	16x100
D790-16-120	16x120
<hr/>	
D790-20-32	20x32
D790-20-36	20x36
D790-20-40	20x40
D790-20-45	20x45
D790-20-50	20x50
D790-20-55	20x55
D790-20-60	20x60
D790-20-70	20x70
D790-20-80	20x80
D790-20-90	20x90
D790-20-100	20x100
D790-20-120	20x120

DIN 7

d	1	1.5	2	2.5	3	4	5	6	8	10	12	14	16	20	25
c máx.	0,15	0,23	0,3	0,4	0,45	0,6	0,75	0,9	1,2	1,5	1,8	2	2,5	3	4
r	1	1,6	2	2,5	3	4	5	6	8	10	12	16	16	20	25

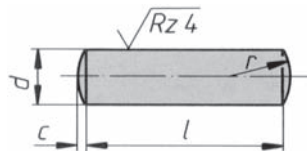

PASADOR CILÍNDRICO

Material 9SMnPb28K

Tolerancia m6.

Referencia	d x l
D70-1-4	1x04
D70-1-6	1x06
D70-1-8	1x08
D70-1-10	1x10
D70-1-12	1x12
D70-1-14	1x14
D70-1-16	1x16
D70-1-18	1x18
D70-1-20	1x20
<hr/>	
D70-1,5-4	1,5x04
D70-1,5-6	1,5x06
D70-1,5-8	1,5x08
D70-1,5-10	1,5x10
D70-1,5-12	1,5x12
D70-1,5-14	1,5x14
D70-1,5-16	1,5x16
D70-1,5-18	1,5x18
D70-1,5-20	1,5x20
D70-1,5-22	1,5x22
D70-1,5-24	1,5x24

sigue

Referencia	d x l
D70-1,5-26	1,5x26
D70-1,5-28	1,5x28
D70-1,5-30	1,5x30
D70-1,5-32	1,5x32
<hr/>	
D70-2-4	2x04
D70-2-6	2x06
D70-2-8	2x08
D70-2-10	2x10
D70-2-12	2x12
D70-2-14	2x14
D70-2-16	2x16
D70-2-18	2x18
D70-2-20	2x20
D70-2-22	2x22
D70-2-24	2x24
D70-2-26	2x26
D70-2-28	2x28
D70-2-30	2x30
D70-2-32	2x32
<hr/>	
D70-2,5-4	2,5x04
D70-2,5-6	2,5x06
D70-2,5-8	2,5x08
D70-2,5-10	2,5x10
D70-2,5-12	2,5x12
D70-2,5-14	2,5x14
D70-2,5-16	2,5x16
D70-2,5-18	2,5x18
D70-2,5-20	2,5x20

sigue ▶



PASADORES

DIN 6325. DIN 7979/D. **DIN 7.** DIN 1B. Pasadores estriados. Remaches estriados.

continuación ▾

Referencia	d x l
D70-2,5-22	2,5x22
D70-2,5-24	2,5x24
D70-2,5-26	2,5x26
D70-2,5-28	2,5x28
D70-2,5-30	2,5x30
D70-2,5-32	2,5x32
D70-2,5-36	2,5x36
D70-2,5-40	2,5x40
<hr/>	
D70-3-4	3x04
D70-3-6	3x06
D70-3-8	3x08
D70-3-10	3x10
D70-3-12	3x12
D70-3-14	3x14
D70-3-16	3x16
D70-3-18	3x18
D70-3-20	3x20
D70-3-22	3x22
D70-3-24	3x24
D70-3-26	3x26
D70-3-28	3x28
D70-3-30	3x30
D70-3-32	3x32
D70-3-36	3x36
D70-3-40	3x40
D70-3-45	3x45
D70-3-50	3x50
D70-3-55	3x55
D70-3-60	3x60
<hr/>	
D70-4-6	4x06
D70-4-8	4x08
D70-4-10	4x10
D70-4-12	4x12
D70-4-14	4x14
D70-4-16	4x16
D70-4-18	4x18
D70-4-20	4x20
D70-4-22	4x22
D70-4-24	4x24
D70-4-26	4x26
D70-4-28	4x28
D70-4-30	4x30
D70-4-32	4x32
D70-4-36	4x36
D70-4-40	4x40
D70-4-45	4x45
D70-4-50	4x50
D70-4-55	4x55
D70-4-60	4x60
D70-4-70	4x70
D70-4-80	4x80
D70-4-90	4x90
D70-4-100	4x100
<hr/>	
D70-5-6	5x06
D70-5-8	5x08
D70-5-10	5x10
D70-5-12	5x12
D70-5-14	5x14
D70-5-16	5x16
D70-5-18	5x18
D70-5-20	5x20
D70-5-22	5x22
D70-5-24	5x24
D70-5-26	5x26
D70-5-28	5x28
D70-5-30	5x30
D70-5-32	5x32
D70-5-36	5x36

Referencia	d x l
D70-5-40	5x40
D70-5-45	5x45
D70-5-50	5x50
D70-5-55	5x55
D70-5-60	5x60
D70-5-70	5x70
D70-5-80	5x80
D70-5-90	5x90
D70-5-100	5x100
<hr/>	
D70-6-6	6x06
D70-6-8	6x08
D70-6-10	6x10
D70-6-12	6x12
D70-6-14	6x14
D70-6-16	6x16
D70-6-18	6x18
D70-6-20	6x20
D70-6-22	6x22
D70-6-24	6x24
D70-6-26	6x26
D70-6-28	6x28
D70-6-30	6x30
D70-6-32	6x32
D70-6-36	6x36
D70-6-40	6x40
D70-6-45	6x45
D70-6-50	6x50
D70-6-55	6x55
D70-6-60	6x60
D70-6-70	6x70
D70-6-80	6x80
D70-6-90	6x90
D70-6-100	6x100
<hr/>	
D70-8-10	8x10
D70-8-12	8x12
D70-8-14	8x14
D70-8-16	8x16
D70-8-18	8x18
D70-8-20	8x20
D70-8-22	8x22
D70-8-24	8x24
D70-8-26	8x26
D70-8-28	8x28
D70-8-30	8x30
D70-8-32	8x32
D70-8-36	8x36
D70-8-40	8x40
D70-8-45	8x45
D70-8-50	8x50
D70-8-55	8x55
D70-8-60	8x60
D70-8-70	8x70
D70-8-80	8x80
D70-8-90	8x90
D70-8-100	8x100
D70-8-120	8x120
<hr/>	
D70-10-10	10x10
D70-10-12	10x12
D70-10-14	10x14
D70-10-16	10x16
D70-10-18	10x18
D70-10-20	10x20
D70-10-22	10x22
D70-10-24	10x24
D70-10-26	10x26
D70-10-28	10x28
D70-10-30	10x30
D70-10-32	10x32

sigue :>

sigue :>



PASADORES

DIN 6325. DIN 7979/D. DIN 7. DIN 1B. Pasadores estriados. Remaches estriados.

continuación ▼

Referencia	d x l
D70-10-36	10x36
D70-10-40	10x40
D70-10-45	10x45
D70-10-50	10x50
D70-10-55	10x55
D70-10-60	10x60
D70-10-70	10x70
D70-10-80	10x80
D70-10-90	10x90
D70-10-100	10x100
D70-10-120	10x120
D70-12-12	12x12
D70-12-14	12x14
D70-12-16	12x16
D70-12-18	12x18
D70-12-20	12x20
D70-12-22	12x22
D70-12-24	12x24
D70-12-26	12x26
D70-12-28	12x28
D70-12-30	12x30
D70-12-32	12x32
D70-12-36	12x36
D70-12-40	12x40
D70-12-45	12x45
D70-12-50	12x50
D70-12-55	12x55
D70-12-60	12x60
D70-12-70	12x70
D70-12-80	12x80
D70-12-90	12x90
D70-12-100	12x100
D70-12-120	12x120
D70-14-20	14x20
D70-14-22	14x22
D70-14-24	14x24
D70-14-26	14x26
D70-14-28	14x28
D70-14-30	14x30
D70-14-32	14x32
D70-14-36	14x36
D70-14-40	14x40
D70-14-45	14x45
D70-14-50	14x50
D70-14-55	14x55
D70-14-60	14x60
D70-14-70	14x70
D70-14-80	14x80
D70-14-90	14x90
D70-14-100	14x100
D70-14-120	14x120

sigue :▶

continuación ▼

Referencia	d x l
D70-16-20	16x20
D70-16-22	16x22
D70-16-24	16x24
D70-16-26	16x26
D70-16-28	16x28
D70-16-30	16x30
D70-16-32	16x32
D70-16-36	16x36
D70-16-40	16x40
D70-16-45	16x45
D70-16-50	16x50
D70-16-55	16x55
D70-16-60	16x60
D70-16-70	16x70
D70-16-80	16x80
D70-16-90	16x90
D70-16-100	16x100
D70-16-120	16x120
D70-20-20	20x20
D70-20-22	20x22
D70-20-24	20x24
D70-20-26	20x26
D70-20-28	20x28
D70-20-30	20x30
D70-20-32	20x32
D70-20-36	20x36
D70-20-40	20x40
D70-20-45	20x45
D70-20-50	20x50
D70-20-55	20x55
D70-20-60	20x60
D70-20-70	20x70
D70-20-80	20x80
D70-20-90	20x90
D70-20-100	20x100
D70-20-120	20x120
D70-25-32	25x32
D70-25-36	25x36
D70-25-40	25x40
D70-25-45	25x45
D70-25-50	25x50
D70-25-55	25x55
D70-25-60	25x60
D70-25-70	25x70
D70-25-80	25x80
D70-25-90	25x90
D70-25-100	25x100
D70-25-120	25x120
D70-25-140	25x140
D70-25-150	25x150

TAMBIÉN DISPONIBLES EN STOCK PASADORES DIN 7977 Y DIN 7978. CONSÚLTENOS

PASADORES ESPECIALES (según plano)

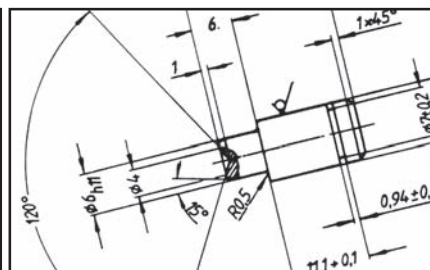
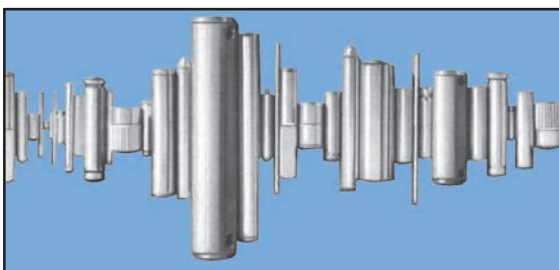

Aceros:
Fácil mecanización, de
rodamientos, cementa-
ción,
inoxidables (templables)-
LATON
ALUMINIO



PASADORES

DIN 6325. DIN 7979/D. DIN 7. **DIN 1B**. Pasadores estriados. Remaches estriados.

DIN 1B

d	1,5	2	2,5	3	4	5	6	8	10	12	14	16	20
c máx.	0,23	0,3	0,4	0,45	0,6	0,75	0,9	1,2	1,5	1,8	2	2,5	3
r	1,5	2	2,5	3	4	5	6	8	10	12	16	16	20

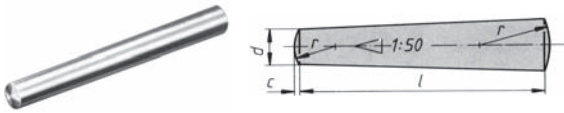

PASADOR CÓNICO

Material 9SMnPb28K

Referencia	d x l
D10-1,5-6	1,5x06
D10-1,5-8	1,5x08
D10-1,5-10	1,5x10
D10-1,5-12	1,5x12
D10-1,5-14	1,5x14
D10-1,5-16	1,5x16
D10-1,5-18	1,5x18
D10-1,5-20	1,5x20
D10-1,5-22	1,5x22
D10-1,5-24	1,5x24
D10-1,5-26	1,5x26
D10-1,5-28	1,5x28
D10-1,5-30	1,5x30
<hr/>	
D10-2-6	2x06
D10-2-8	2x08
D10-2-10	2x10
D10-2-12	2x12
D10-2-14	2x14
D10-2-16	2x16
D10-2-18	2x18
D10-2-20	2x20
D10-2-22	2x22
D10-2-24	2x24
D10-2-26	2x26
D10-2-28	2x28
D10-2-30	2x30
D10-2-32	2x32
D10-2-36	2x36
D10-2-40	2x40
D10-2-45	2x45
D10-2-50	2x50
<hr/>	
D10-2,5-6	2-5x06
D10-2,5-8	2-5x08
D10-2,5-10	2-5x10
D10-2,5-12	2-5x12
D10-2,5-14	2-5x14
D10-2,5-16	2-5x16
D10-2,5-18	2-5x18
D10-2,5-20	2-5x20
D10-2,5-22	2-5x22
D10-2,5-24	2-5x24
D10-2,5-26	2-5x26
D10-2,5-28	2-5x28
D10-2,5-30	2-5x30
D10-2,5-32	2-5x32
D10-2,5-36	2-5x36
D10-2,5-40	2-5x40
D10-2,5-45	2-5x45
D10-2,5-50	2-5x50
<hr/>	
D10-3-6	3x06
D10-3-8	3x08

continuación ▼

Referencia	d x l
D10-3-10	3x10
D10-3-12	3x12
D10-3-14	3x14
D10-3-16	3x16
D10-3-18	3x18
D10-3-20	3x20
D10-3-22	3x22
D10-3-24	3x24
D10-3-26	3x26
D10-3-28	3x28
D10-3-30	3x30
D10-3-32	3x32
D10-3-36	3x36
D10-3-40	3x40
D10-3-45	3x45
D10-3-50	3x50
D10-3-55	3x55
D10-3-60	3x60
D10-3-65	3x65
D10-3-70	3x70
D10-3-80	3x80
D10-3-90	3x90
D10-3-100	3x100
<hr/>	
D10-4-6	4x06
D10-4-8	4x08
D10-4-10	4x10
D10-4-12	4x12
D10-4-14	4x14
D10-4-16	4x16
D10-4-18	4x18
D10-4-20	4x20
D10-4-22	4x22
D10-4-24	4x24
D10-4-26	4x26
D10-4-28	4x28
D10-4-30	4x30
D10-4-32	4x32
D10-4-36	4x36
D10-4-40	4x40
D10-4-45	4x45
D10-4-50	4x50
D10-4-55	4x55
D10-4-60	4x60
D10-4-65	4x65
D10-4-70	4x70
D10-4-80	4x80
D10-4-90	4x90
D10-4-100	4x100
<hr/>	
D10-5-10	5x10
D10-5-12	5x12
D10-5-14	5x14
D10-5-16	5x16
D10-5-18	5x18
D10-5-20	5x20
D10-5-22	5x22
D10-5-24	5x24
D10-5-26	5x26
D10-5-28	5x28
D10-5-30	5x30

sigue :▶

sigue :▶



PASADORES

DIN 6325. DIN 7979/D. DIN 7. **DIN 1B**. Pasadores estriados. Remaches estriados.

continuación ▼

Referencia	d x l
D10-5-32	5x32
D10-5-36	5x36
D10-5-40	5x40
D10-5-45	5x45
D10-5-50	5x50
D10-5-55	5x55
D10-5-60	5x60
D10-5-65	5x65
D10-5-70	5x70
D10-5-80	5x80
D10-5-90	5x90
D10-5-100	5x100
<hr/>	
D10-6-10	6x10
D10-6-12	6x12
D10-6-14	6x14
D10-6-16	6x16
D10-6-18	6x18
D10-6-20	6x20
D10-6-22	6x22
D10-6-24	6x24
D10-6-26	6x26
D10-6-28	6x28
D10-6-30	6x30
D10-6-32	6x32
D10-6-36	6x36
D10-6-40	6x40
D10-6-45	6x45
D10-6-50	6x50
D10-6-55	6x55
D10-6-60	6x60
D10-6-65	6x65
D10-6-70	6x70
D10-6-80	6x80
D10-6-90	6x90
D10-6-100	6x100
D10-6-110	6x110
D10-6-120	6x120
<hr/>	
D10-8-20	8x20
D10-8-22	8x22
D10-8-24	8x24
D10-8-26	8x26
D10-8-28	8x28
D10-8-30	8x30
D10-8-32	8x32
D10-8-36	8x36
D10-8-40	8x40
D10-8-45	8x45
D10-8-50	8x50
D10-8-55	8x55
D10-8-60	8x60
D10-8-65	8x65
D10-8-70	8x70
D10-8-80	8x80
D10-8-90	8x90
D10-8-100	8x100
D10-8-110	8x110
D10-8-120	8x120
<hr/>	
D10-10-28	10x28
D10-10-30	10x30
D10-10-32	10x32
D10-10-36	10x36
D10-10-40	10x40
D10-10-45	10x45
D10-10-50	10x50
D10-10-55	10x55
D10-10-60	10x60
D10-10-65	10x65
D10-10-70	10x70

continuación ▼

Referencia	d x l
D10-10-80	10x80
D10-10-90	10x90
D10-10-100	10x100
D10-10-110	10x110
D10-10-120	10x120
<hr/>	
D10-12-30	12x30
D10-12-32	12x32
D10-12-36	12x36
D10-12-40	12x40
D10-12-45	12x45
D10-12-50	12x50
D10-12-55	12x55
D10-12-60	12x60
D10-12-65	12x65
D10-12-70	12x70
D10-12-80	12x80
D10-12-90	12x90
D10-12-100	12x100
D10-12-110	12x110
D10-12-120	12x120
<hr/>	
D10-14-36	14x36
D10-14-40	14x40
D10-14-45	14x45
D10-14-50	14x50
D10-14-55	14x55
D10-14-60	14x60
D10-14-65	14x65
D10-14-70	14x70
D10-14-80	14x80
D10-14-90	14x90
D10-14-100	14x100
D10-14-110	14x110
D10-14-120	14x120
D10-14-130	14x130
D10-14-140	14x140
D10-14-150	14x150
<hr/>	
D10-16-36	16x36
D10-16-40	16x40
D10-16-45	16x45
D10-16-50	16x50
D10-16-55	16x55
D10-16-60	16x60
D10-16-65	16x65
D10-16-70	16x70
D10-16-80	16x80
D10-16-90	16x90
D10-16-100	16x100
D10-16-110	16x110
D10-16-120	16x120
D10-16-130	16x130
D10-16-140	16x140
D10-16-150	16x150
<hr/>	
D10-20-40	20x40
D10-20-45	20x45
D10-20-50	20x50
D10-20-55	20x55
D10-20-60	20x60
D10-20-65	20x65
D10-20-70	20x70
D10-20-80	20x80
D10-20-90	20x90
D10-20-100	20x100
D10-20-110	20x110
D10-20-120	20x120
D10-20-130	20x130
D10-20-140	20x140
D10-20-150	20x150

sigue :▶



PASADORES

DIN 6325. DIN 7979/D. DIN 7. DIN 1B. **PASADORES ESTRIADOS.** Remaches estriados.

DIN 1469* PASADOR AJUSTADO ESTRIADO CON CUELLO

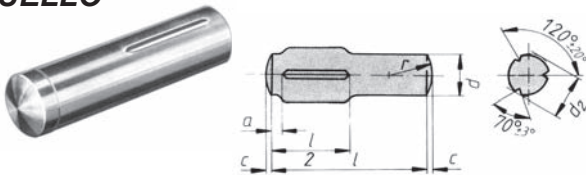

*Artículo bajo consulta

DIN 1471 PASADOR CÓNICO ESTRIADO

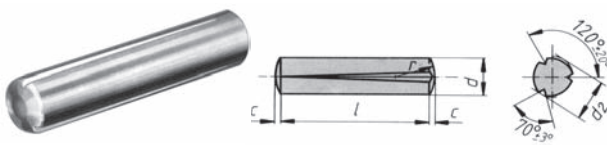

DIN 1470 PASADOR CILÍNDRICO ESTRIADO

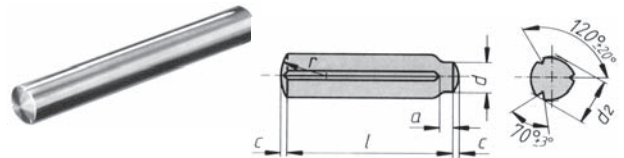

DIN 1472 PASADOR AJUSTADO ESTRIADO

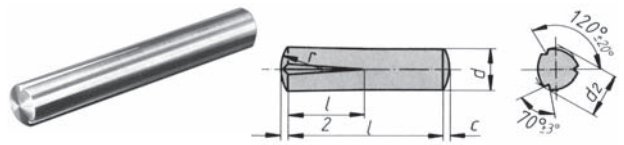

DIN 1473 PASADOR CILÍNDRICO ESTRIADO

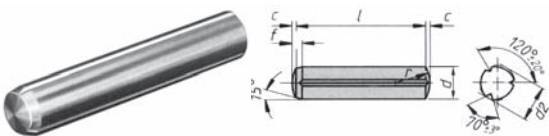

DIN 1474 PASADOR ESTRIADO CON ESPIGA CILÍNDRICA

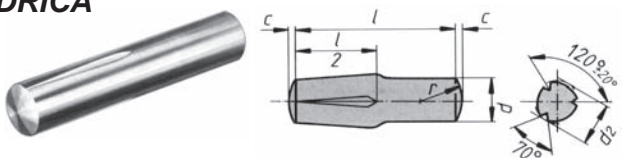

DIN 1475 PASADOR CILÍNDRICO CON ESTRIADO CENTRAL

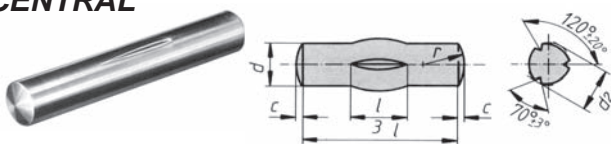

CARACTERÍSTICAS TÉCNICAS

Material: 9SMnPb28K

Bajo pedido, también suministrable en:

- Acero Inoxidable
- Aluminio
- Latón
- PVC

d tolerancia	1	1,2	1,5	2	2,5	3	4	5	6	8	10	12	
	h9						h11						
dif. adm. d2	0 / +0,05						±0,05						±0,1
a	--	--	0,7	0,7	1	1	1,5	1,5	2	2	2,5	2,5	
c	0,12	0,16	0,2	0,25	0,3	0,4	0,5	0,6	0,8	1	1,2	1,6	
f	0,57	0,6	0,8	0,9	1,2	1,3	1,8	2	2,5	2,8	3,5	3,7	
Cizalladura kN mín	0,70	1,00	1,60	2,85	4,25	6,15	10,60	16,50	22,80	40,50	63,20	91,00	



PASADORES

DIN 6325. DIN 7979/D. DIN 7. DIN 1B. **PASADORES ESTRIADOS.** Remaches estriados.

CÓMO CREAR LA REFERENCIA

Ejemplo de elección

DIN:

DIN 1470 = 70

d x l
1 x 6

Referencia
K700-1-6

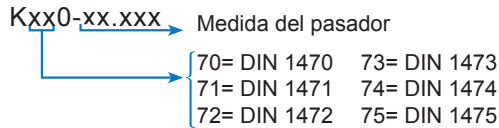

PASADORES ESTRIADOS

DIN 1469 - 1470 - 1471 - 1472

1473 - 1474 - 1475

Referencia	d x l
Kxx0-1-4	1x04
Kxx0-1-5	1x05
Kxx0-1-6	1x06
Kxx0-1-8	1x08
Kxx0-1-10	1x10
Kxx0-1,2-4	1,2x04
Kxx0-1,2-5	1,2x05
Kxx0-1,2-6	1,2x06
Kxx0-1,2-8	1,2x08
Kxx0-1,2-10	1,2x10
Kxx0-1,5-4	1,5x04
Kxx0-1,5-5	1,5x05
Kxx0-1,5-6	1,5x06
Kxx0-1,5-8	1,5x08
Kxx0-1,5-10	1,5x10
Kxx0-1,5-12	1,5x12
Kxx0-1,5-14	1,5x14
Kxx0-1,5-16	1,5x16
Kxx0-1,5-18	1,5x18
Kxx0-1,5-20	1,5x20
Kxx0-2-4	2x04
Kxx0-2-5	2x05
Kxx0-2-6	2x06
Kxx0-2-8	2x08
Kxx0-2-10	2x10
Kxx0-2-12	2x12
Kxx0-2-14	2x14
Kxx0-2-16	2x16
Kxx0-2-18	2x18
Kxx0-2-20	2x20
Kxx0-2-22	2x22
Kxx0-2-24	2x24
Kxx0-2-26	2x26
Kxx0-2-28	2x28
Kxx0-2-30	2x30
Kxx0-2,5-6	2,5x06
Kxx0-2,5-8	2,5x08
Kxx0-2,5-10	2,5x10
Kxx0-2,5-12	2,5x12
Kxx0-2,5-14	2,5x14
Kxx0-2,5-16	2,5x16
Kxx0-2,5-18	2,5x18
Kxx0-2,5-20	2,5x20
Kxx0-2,5-22	2,5x22
Kxx0-2,5-24	2,5x24
Kxx0-2,5-26	2,5x26
Kxx0-2,5-28	2,5x28
Kxx0-2,5-30	2,5x30

continuación ▼

Referencia	d x l
Kxx0-3-6	3x06
Kxx0-3-8	3x08
Kxx0-3-10	3x10
Kxx0-3-12	3x12
Kxx0-3-14	3x14
Kxx0-3-16	3x16
Kxx0-3-18	3x18
Kxx0-3-20	3x20
Kxx0-3-22	3x22
Kxx0-3-24	3x24
Kxx0-3-26	3x26
Kxx0-3-28	3x28
Kxx0-3-30	3x30
Kxx0-4-6	4x06
Kxx0-4-8	4x08
Kxx0-4-10	4x10
Kxx0-4-12	4x12
Kxx0-4-14	4x14
Kxx0-4-16	4x16
Kxx0-4-18	4x18
Kxx0-4-20	4x20
Kxx0-4-22	4x22
Kxx0-4-24	4x24
Kxx0-4-26	4x26
Kxx0-4-28	4x28
Kxx0-4-30	4x30
Kxx0-4-32	4x32
Kxx0-4-36	4x36
Kxx0-4-40	4x40
Kxx0-4-45	4x45
Kxx0-5-8	5x08
Kxx0-5-10	5x10
Kxx0-5-12	5x12
Kxx0-5-14	5x14
Kxx0-5-16	5x16
Kxx0-5-18	5x18
Kxx0-5-20	5x20
Kxx0-5-22	5x22
Kxx0-5-24	5x24
Kxx0-5-26	5x26
Kxx0-5-28	5x28
Kxx0-5-30	5x30
Kxx0-5-32	5x32
Kxx0-5-36	5x36
Kxx0-5-40	5x40
Kxx0-5-45	5x45
Kxx0-6-10	6x10
Kxx0-6-12	6x12
Kxx0-6-14	6x14
Kxx0-6-16	6x16
Kxx0-6-18	6x18
Kxx0-6-20	6x20
Kxx0-6-22	6x22
Kxx0-6-24	6x24
Kxx0-6-26	6x26
Kxx0-6-28	6x28
Kxx0-6-30	6x30
Kxx0-6-32	6x32
Kxx0-6-36	6x36
Kxx0-6-40	6x40
Kxx0-6-45	6x45
Kxx0-6-50	6x50
Kxx0-6-55	6x55
Kxx0-6-60	6x60

sigue : ▶

sigue : ▶

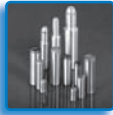

PASADORES

DIN 6325. DIN 7979/D. DIN 7. DIN 1B. PASADORES ESTRIADOS. REMACHES ESTRIADOS.

continuación ▾

Referencia	d x l
Kxx0-8-12	8x12
Kxx0-8-14	8x14
Kxx0-8-16	8x16
Kxx0-8-18	8x18
Kxx0-8-20	8x20
Kxx0-8-22	8x22
Kxx0-8-24	8x24
Kxx0-8-26	8x26
Kxx0-8-28	8x28
Kxx0-8-30	8x30
Kxx0-8-32	8x32
Kxx0-8-36	8x36
Kxx0-8-40	8x40
Kxx0-8-45	8x45
Kxx0-8-50	8x50
Kxx0-8-55	8x55
Kxx0-8-60	8x60
Kxx0-8-65	8x65
Kxx0-8-70	8x70

Referencia	d x l
Kxx0-10-14	10x14
Kxx0-10-16	10x16
Kxx0-10-18	10x18
Kxx0-10-20	10x20
Kxx0-10-22	10x22
Kxx0-10-24	10x24
Kxx0-10-26	10x26
Kxx0-10-28	10x28
Kxx0-10-30	10x30
Kxx0-10-32	10x32
Kxx0-10-36	10x36
Kxx0-10-40	10x40

sigue

continuación ▾

Referencia	d x l
Kxx0-10-45	10x45
Kxx0-10-50	10x50
Kxx0-10-55	10x55
Kxx0-10-60	10x60
Kxx0-10-65	10x65
Kxx0-10-70	10x70
Kxx0-10-80	10x80
Kxx0-10-90	10x90
Kxx0-10-100	10x100
Kxx0-10-110	10x110
Kxx0-10-120	10x120
<hr/>	
Kxx0-12-14	12x14
Kxx0-12-16	12x16
Kxx0-12-18	12x18
Kxx0-12-20	12x20
Kxx0-12-22	12x22
Kxx0-12-24	12x24
Kxx0-12-26	12x26
Kxx0-12-28	12x28
Kxx0-12-30	12x30
Kxx0-12-32	12x32
Kxx0-12-36	12x36
Kxx0-12-40	12x40
Kxx0-12-45	12x45
Kxx0-12-50	12x50
Kxx0-12-55	12x55
Kxx0-12-60	12x60
Kxx0-12-65	12x65
Kxx0-12-70	12x70
Kxx0-12-80	12x80
Kxx0-12-90	12x90
Kxx0-12-100	12x100
Kxx0-12-110	12x110
Kxx0-12-120	12x120

DIN 1476

REMACHE REDONDO ESTRIADO

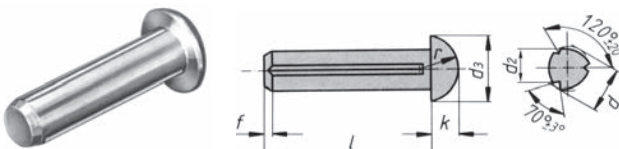

DIN 1477

REMACHE AVELLANADO ESTRIADO

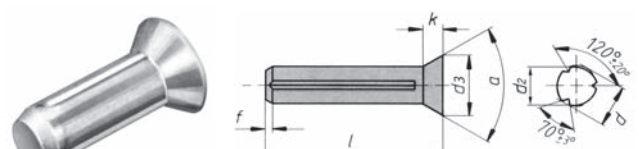

d	1,6	2	2,5	3	4	5	6
dif. admisible	0 / -0,05		0 / -0,75		0 / -0,10		
dif. adm. d2	0 / +0,05		±0,05				
k (Din 1476)	1,0	1,2	1,5	1,8	2,4	3,0	3,6
dif. admisible	±0,1			±0,15			
k (Din 1477)	0,8	1,0	1,2	1,4	2,0	2,5	3,0
dif. admisible	±0,1			±0,15			
r	1,6	1,9	2,4	2,8	3,8	4,6	5,7
f	0,5		0,7	1	1,5		2

Material: QSt 36-3 ó RQSt 37-2

CÓMO CREAR LA REFERENCIA

Ejemplo de elección

DIN:

DIN 1476 = 76

d x l

1,6 x 4

Referencia

K760-1,6-4

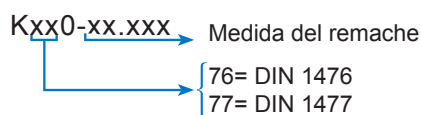

REMACHES ESTRIADOS

DIN 1476 - 1477

Referencia	d x l
Kxx0-1,6-3	1,6x03
Kxx0-1,6-4	1,6x04

sigue :▶



PASADORES

DIN 6325. DIN 7979/D. DIN 7. DIN 1B. Pasadores Estriados. **REMACHES ESTRIADOS.**

continuación ▼

Referencia	d x l
Kxx0-1,6-5	1,6x05
Kxx0-1,6-6	1,6x06
Kxx0-1,6-7	1,6x07
<hr/>	
Kxx0-1,7-3	1,7x03
Kxx0-1,7-4	1,7x04
Kxx0-1,7-5	1,7x05
Kxx0-1,7-6	1,7x06
Kxx0-1,7-7	1,7x07
<hr/>	
Kxx0-2-3	2x03
Kxx0-2-4	2x04
Kxx0-2-5	2x05
Kxx0-2-6	2x06
Kxx0-2-7	2x07
Kxx0-2-8	2x08
Kxx0-2-10	2x10
<hr/>	
Kxx0-2,3-3	2,3x03
Kxx0-2,3-4	2,3x04
Kxx0-2,3-5	2,3x05
Kxx0-2,3-6	2,3x06
Kxx0-2,3-7	2,3x07
Kxx0-2,3-8	2,3x08
Kxx0-2,3-10	2,3x10
<hr/>	
Kxx0-2,5-3	2,5x03
Kxx0-2,5-4	2,5x04
Kxx0-2,5-5	2,5x05
Kxx0-2,5-6	2,5x06
Kxx0-2,5-7	2,5x07
Kxx0-2,5-8	2,5x08
Kxx0-2,5-10	2,5x10
<hr/>	
Kxx0-2,6-3	2,6x03
Kxx0-2,6-4	2,6x04
Kxx0-2,6-5	2,6x5
Kxx0-2,6-6	2,6x06
Kxx0-2,6-7	2,6x07
Kxx0-2,6-8	2,6x8
Kxx0-2,6-10	2,6x10

Bajo pedido, también suministrable en acero inoxidable, aluminio, latón y PVC.

sigue

continuación ▼

Referencia	d x l
Kxx0-3-4	3x04
Kxx0-3-5	3x05
Kxx0-3-6	3x06
Kxx0-3-7	3x07
Kxx0-3-8	3x08
Kxx0-3-10	3x10
Kxx0-3-12	3x12
Kxx0-3-15	3x15
Kxx0-3-18	3x18
<hr/>	
Kxx0-4-6	4x06
Kxx0-4-7	4x07
Kxx0-4-8	4x08
Kxx0-4-10	4x10
Kxx0-4-12	4x12
Kxx0-4-15	4x15
Kxx0-4-18	4x18
Kxx0-4-20	4x20
<hr/>	
Kxx0-5-7	5x7
Kxx0-5-8	5x8
Kxx0-5-10	5x10
Kxx0-5-12	5x12
Kxx0-5-15	5x15
Kxx0-5-18	5x18
Kxx0-5-20	5x20
Kxx0-5-22	5x22
Kxx0-5-25	5x25
<hr/>	
Kxx0-6-7	6x07
Kxx0-6-8	6x08
Kxx0-6-10	6x10
Kxx0-6-12	6x12
Kxx0-6-15	6x15
Kxx0-6-18	6x18
Kxx0-6-20	6x20
Kxx0-6-22	6x22
Kxx0-6-25	6x25
Kxx0-6-28	6x28
Kxx0-6-30	6x30
Kxx0-6-32	6x32
Kxx0-6-36	6x36

INFORMACIÓN ACERCA DE LOS PASADORES DE ACERO

100 Cr6

Para que un pasador templado tenga el mejor comportamiento cuando este sometido al máximo esfuerzo y ser denominado de **ALTA RESISTENCIA** debe estar fabricado con **100 Cr 6**.

Algunos fabricantes le aseguran que ellos también fabrican en 100 Cr 6 pero **nosotros se lo GARANTIZAMOS**

¿COMO SE LO GARANTIZAMOS?

Nuestra empresa recibe la **materia prima en bobinas de hilo** de aproximadamente 1.000 Kgs. y nuestro departamento de calidad hace **una probeta de cada bobina** para certificar la composición química del material. Nosotros no empleamos materiales en varillas calibradas que pueden venir mezcladas de varias coladas y por lo tanto tener distintas composiciones.

ESTA ES NUESTRA GARANTÍA SOBRE EL MATERIAL

Todos nuestros procesos de fabricación están avalados con la certificación **ISO 9001** y la normativa de la asociación de fabricantes de la industria de automóviles **VDA**.

